

PO20 INK DISPENSER

COLOUR MANAGEMENT EQUIPMENT

Suitable for
UV and Conventional
Offset inks,
Concentrates, Plastisols,
and High Viscosity
Materials



PO20

Applications

The PO20 dispenser is a medium duty, integrated press-out system, designed for high viscosity ink ranges such as offset and concentrates.

Benefits

The PO20 is constructed as a standalone, fully integrated machine incorporating up to 24 ink reservoirs, each with a capacity of 20Kg.

It is compact in design with a footprint of 55"(140mm) x 100"(2500mm) for a typical 12 colour system.

Options are available for external pumped modules to allow the dispensing of all bulk components such as high pigmented base inks, varnishes and extenders from 205 litre barrels or IBCs.

Remote access feature allows direct link with the ink supplier, colour centre and the Technical Support Team providing on-line training and software maintenance.

 The Vale-Tech Ink Manager™ software ensures complete control of the dispensing and colour blending process.

Features

- PANTONE® licensed software.
- Long life dispense valves, incorporating Teflon seals and anti-drip nozzles
- Incorporates the Vale-Tech range of high accuracy, stainless steel enclosed balances
- Refillable 20kg capacity reservoirs
- Up to 24 valves
- Blending colour batches from 100g to 10kg to an accuracy of +/- 0.2g
- Ink reservoir incorporates ink level sensor

Bringing high reliability, compact size and simple operation together, Vale-Tech has designed the ideal vehicle for higher productivity, reduced ink wastage and significantly improved colour control.

PO20 INK DISPENSER

COLOUR MANAGEMENT EQUIPMENT

VALE-TECH
Dispensing Solutions Worldwide
www.vale-tech.com

TECHNICAL INFORMATION

Main module: 55" (1400 mm) x 100" (2500 mm)
(extension modules available: 2, 4 or 6 colours)

Approx. weights: 6 colours - 760Kg 12 colours - 1330Kg
14 colours - 1570Kg 16 colours - 1810Kg
18 colours - 2050Kg

Services:

Electrical: 3 phase neutral and earth, 10 Amp
Air supply: 6-8 Bar (85-110 psi) clean and filtered

No. of reservoirs: up to 24 x 20Kg capacity

Blend size: 100g to 10kg (option for 25Kg)

Weigh range: up to 10Kg in increments of 0.2g

Dispense valve: Air operated double actuator, fine/coarse,
incorporating PTFE (Teflon) diaphragm seals

Dispense rate: Typically 5 minutes for a 5Kg blend

Options: Extension modules for pumping bulk materials

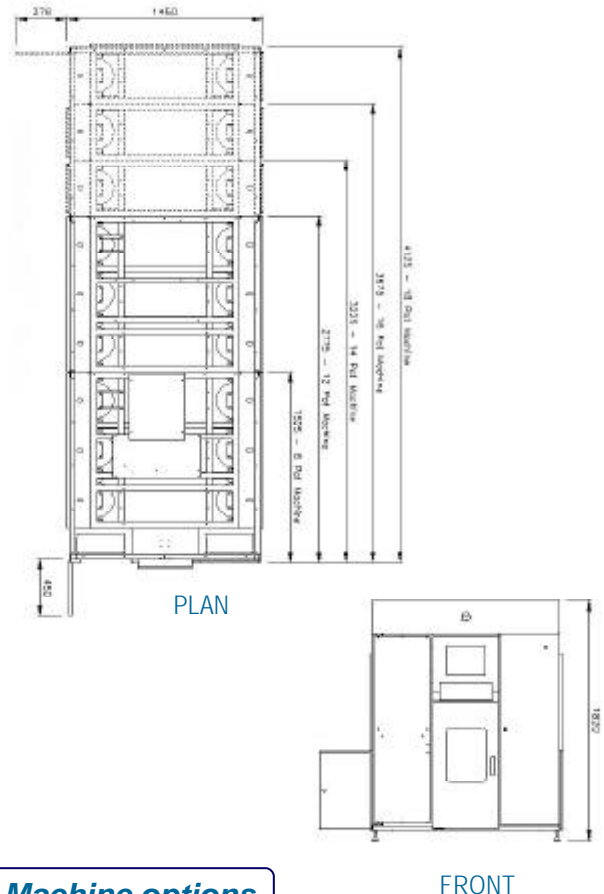

PO20 Series of Dispensers

PO2012 comprises 10kg Balance, 12 double actuator dispense valves and 12 x 20kg reservoirs.

PO2016 comprises 10kg Balance, 16 double actuator dispense valves and 16 x 20kg reservoirs.

PO2020 comprises 10kg Balance, 20 double actuator dispense valves and 20 x 20kg reservoirs.

PO2024 comprises 10kg Balance, 24 double actuator dispense valves and 24 x 20kg reservoirs.

Machine options

CQ or VQ AUTO-FEED Queuing systems to be added to your dispenser, allowing up to 12 blends to be produced automatically and seamlessly.

LV205-10 Bulk material extension. 205 litres drum dispenser to deliver high usage materials from drums. Other options available.

LLK Remote access pack. Either telephone or server based communications utilising Laplink PC software. Includes headset and camera.

SP-1 Scan Pack. Barcode labelling and scanning package. Includes barcode label printer, laser printer, hand-held laser scanner and software.

SP-2 As SP-1 but excludes laser printer.

SL Spectro link to Gretag, X-Rite® and Datacolor systems

PO20-25Kg balance upgrade. High capacity balance assembly allow blends of up to 25Kg (5 gallons).

PANTONE® is a registered trademark of Pantone, Inc.

Manufactured by VALE-TECH LTD
12 Depot Road, Newmarket, Suffolk, CB8 0AL, UK
e-mail : sales@vale-tech.com
TEL: +44 (0)1638 668583 FAX: +44 (0)1638 676720
www.vale-tech.com